

## Load Monitoring - Crane Scales

# Ron 2501 Hook Type Wireless Crane Scale

## ADVANTAGES



### 5 year warranty

**Portable:** Lightweight and small.

**Highly Accurate:**  $\pm 0.1\%$  of full range - important for early overload detection.

**Long transmission Range:** Up to 150m/yds. Up to 3.2 Km / 2 Miles upon request (outdoor, line of sight).

**Excellent battery life:** Up to 2000 Hours (2x AA batteries).  
Optional 4000h.

**Quality Materials:** Exclusive use of high strength aerospace quality steel for load cell bodies.

**Fatigue rated:** All Eilon Engineering load cells are Fatigue Rated according to ASME BTH-1 and IEC 61508. Fatigue Rated means an unlimited number of load cycles (Provided capacity is not exceeded).

**Robust:** Heavy duty designs with shock absorbing mechanisms.

**Unique:** Shackle holes offset 90 degrees reduce external moments for greater safety and accuracy.

**Minimal Headroom loss:** Smallest on the market - important for indoor applications.

**Multi-point:** Up to 200 different load cells controlled by a single receiver and all measurements are presented on one screen as a real time load map.

**Advanced options:** Auto/Manual Data Logger, RS232, Additional Displays.

**Short delivery time:** In most cases 48-72 hours.

**More than 45 years** in the market with repeat customers such as NASA, Boeing, Cirque du Soleil, Disney, GE, Lockheed Martin, other Fortune 500 companies, as well as numerous small businesses.



## TECHNICAL SPECIFICATIONS



**Safety factor:** Load cell body - 5:1. Hook - at least 4:1

**Accuracy:** 0.1% of full range.

**Transmission Range:** Up to 150m/yds. Up to 3.2 Km / 2 Miles upon request (outdoor, line of sight).

**Calibration:** User calibration. Initial factory calibration, fully traceable (certified).

**Load Cell Material:** high-strength, aerospace quality, alloy steel, polyurethane coated.

**Proof Load:** Each system proof-loaded to 200% of capacity (certified)

**Display:** 6 digits, 1/2" (12mm) liquid crystal display. Overload warnings (100%/130%), low battery indication, Gross/Net. Refresh rate 1Hz.

**Sampling Rate:** 200 per second.

**Functions:** Zero, Tare, Battery level indication, Low battery warning, Max. (peak hold), User calibration.

**Units:** User selectable units (metric tons, short tons, kgs., lbs., Newtons, Deca-Newtons, Kilo-Newtons).

**Indicator/Load Cell Housing:** High quality ABS.

### Temperature Range:

Load cell:  $-15^{\circ}\text{F}$  to  $+175^{\circ}\text{F}$  ( $-25^{\circ}\text{C}$  to  $+80^{\circ}\text{C}$ )

Indicator:  $-4^{\circ}\text{F}$  to  $+158^{\circ}\text{F}$  ( $-20^{\circ}\text{C}$  to  $+70^{\circ}\text{C}$ )

### Environmental:

Load Cell: IP67

Indicator: IP65

Capacities 0.5t - 15t  
(Clevis Hook)

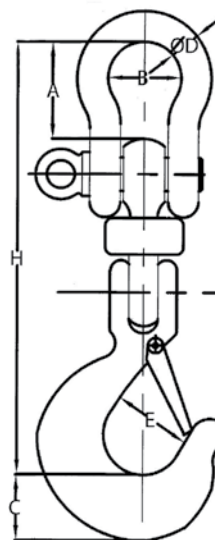

Capacities 20t - 30t  
(Eye Hook)

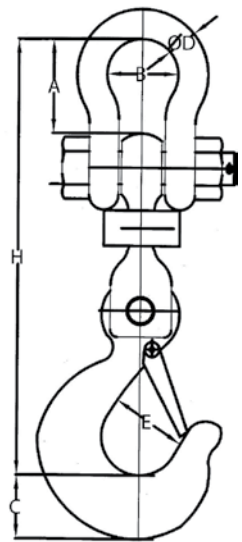

Cat no.	Capacity		Resolution		A		B		C*		Ø D		E*		H	
	ton	kg.	lbs	mm.	inch	mm.	inch	mm.	inch	mm.	inch	mm.	inch	mm.	inch	
H-005	0.5	0.1	0.2	30	1.2	26	1	28	1.1	10	0.4	25	1	235	9.3	
H-01	1	0.2	0.5	30	1.2	26	1	28	1.1	10	0.4	25	1	235	9.3	
H-0125	1.25	0.2	0.5	30	1.2	26	1	28	1.1	10	0.4	25	1	235	9.3	
H-016	1.6	0.5	1	30	1.2	26	1	28	1.1	10	0.4	25	1	235	9.3	
H-02	2	0.5	1	40	1.6	33	1.3	36	1.4	13	0.5	34	1.3	279	11	
H-025	2.5	0.5	1	40	1.6	33	1.3	36	1.4	13	0.5	34	1.3	279	11	
H-03	3	0.5	1	40	1.6	33	1.3	36	1.4	13	0.5	34	1.3	279	11	
H-032	3.2	0.5	1	40	1.6	33	1.3	36	1.4	13	0.5	34	1.3	279	11	
H-05	5	1	2	50	2	43	1.7	34	1.4	16	0.6	41	1.6	334	13.2	
H-10	10	2	5	82	3.2	68	2.7	58	2.3	25	1	56	2.2	440	17.3	
H-12	12.5	2	5	82	3.2	68	2.7	58	2.3	25	1	56	2.2	440	17.3	
H-15	15	2	5	104	4.1	82	3.2	64	2.5	33	1.3	57	2.2	508	20	
H-20	20	5	10	137	5.3	111	4.3	79	3.1	41	1.6	71	2.8	621	24.5	
H-25	25	5	10	169	6.6	146	5.7	91	3.6	51	2	94	3.7	719	28.3	
H-30	30	5	10	169	6.6	146	5.7	91	3.6	51	2	94	3.7	719	28.3	
H-315	31.5	5	10	169	6.6	146	5.7	91	3.6	51	2	94	3.7	719	28.9	
H-32	32	5	10	169	6.6	146	5.7	89	3.5	51	2	87	3.4	643	25.3	

> The company reserves the right to make changes without notice.

\* C & E dimensions subject to change. For current dimensions - contact us.

## OPTIONS



- > Optional Backlight
- > Additional 0.5"/12mm LCD display with cable connection to indicator or wireless
- > Additional 1"/25mm LCD display with cable connection to indicator or wireless
- > Additional 2"/50mm LCD display with cable connection to indicator or wireless
- > Additional 5"/125mm LED display with cable connection to indicator or wireless
- > Battery life: Extended battery life of up to 4000 hours
- > Dampened display for unstable loads
- > Automatic/Manual Data Logger - Up to 50,000 measurements
- > Multi-cell: Up to 8 different load cells controlled by a single indicator.
- > Multiple load monitoring: up to 200 load cells, please see Ron StageMaster
- > Number of measurements per second: 1, 2, 3, factory set

- > Real-time clock: date, hour, minute, second adds time stamp to RS-232 output
- > Robust, extruded aluminum, hand-held indicator instead of ABS (1"/25mm or 2"/50mm digits)
- > Rechargeable batteries with an external charger.
- > RS-232 - continuous or on demand data output, user-selectable
- > RS-485 - continuous or on demand data output, user-selectable
- > Totalizer
- > Totalizer with Data Logging
- > USB

### High Temperature Options:

- > Heat shield for the load cell
- > Internal load cell thermometer for load cell temperature display on the hand-held indicator
- > Optional Backlight
- > Dampened display for unstable loads