

## Load Monitoring - Crane Scales

# Ron 2000 Hook Type Crane Scale with Remote Indicator

## ADVANTAGES



### 5 year warranty

**Portable:** Lightweight and small.

**Highly Accurate:**  $\pm 0.1\%$  of full range - important for early overload detection.

**Excellent battery life:** Up to 2000 Hours (2x AA batteries).

**Quality Materials:** Exclusive use of high strength aerospace quality steel for load cell bodies.

**Meets Standards:** All Eilon Engineering load cells are **Fatigue Rated** according to ASME BTH-1-2017, ASME B30.26 and IEC 61508.

**Robust:** Heavy duty designs with shock absorbing mechanisms.

**Unique:** Shackle holes offset 90 degrees reduce external moments for greater safety and accuracy.

**Minimal Headroom loss:** Smallest on the market - important for indoor applications.

**Advanced options:** Auto/Manual Data Logger, RS232, Additional Displays.

**Short delivery time:** In most cases 48-72 hours.

**More than 40 years** in the market with repeat customers such as NASA, Boeing, Cirque du Soleil, Disney, GE, Lockheed Martin, other Fortune 500 companies, as well as numerous small businesses.



## TECHNICAL SPECIFICATIONS



**Safety factor:** Load cell body - 5:1. Hook - at least 4:1

**Accuracy:** 0.1% of full range.

**Calibration:** User calibration. Initial factory calibration, fully traceable (certified).

**Proof Load:** Each system proof-loaded to 200% of capacity (certified)

**Display:** 6 digits, 1/2" (12mm) liquid crystal display. Overload warnings (100%/130%), Max (peak hold), low battery indication, Gross/Net. Refresh rate 1Hz.

**Cable:** 15" / 5m cable.

**Sampling Rate:** 200 per second.

**Functions:** Zero. Tare. Battery charge level indication. Low battery warning. Max. (peak hold). User calibration. Sleep mode, wakes automatically when loaded.

**Units:** User selectable units (metric tons, short tons, kgs., lbs., Newtons, Deca-Newtons, Kilo-Newtons).

**Housing:** High quality ABS.

### Temperature Range:

Load cell:  $-15^{\circ}\text{F}$  to  $+175^{\circ}\text{F}$  ( $-25^{\circ}\text{C}$  to  $+80^{\circ}\text{C}$ ).

Indicator:  $-4^{\circ}\text{F}$  to  $+158^{\circ}\text{F}$  ( $-20^{\circ}\text{C}$  to  $+70^{\circ}\text{C}$ ).

**Environmental:** IP65 (Optional IP67 Load Cell).

Capacities 0.5t - 15t  
(Clevis Hook)

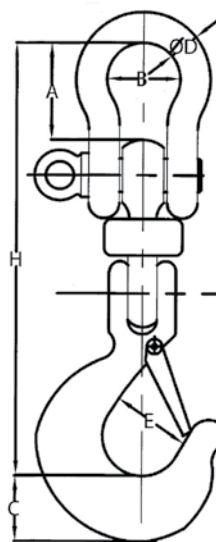

Capacities 20t - 30t  
(Eye Hook)

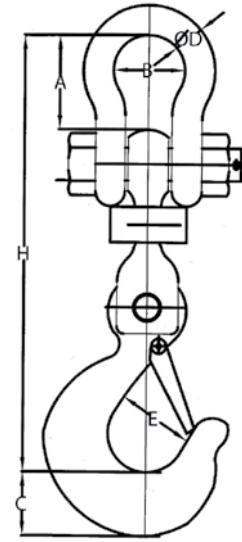

Cat no.	Capacity		Resolution		A		B		C*		Ø D		E*		H	
	ton	kg.	lbs	mm.	inch	mm.	inch	mm.	inch	mm.	inch	mm.	inch	mm.	inch	
H-005	0.5	0.2	0.5	30	1.2	26	1	28	1.1	10	0.4	25	1	235	9.3	
H-01	1	0.5	1	30	1.2	26	1	28	1.1	10	0.4	25	1	235	9.3	
H-0125	1.25	0.5	1	30	1.2	26	1	28	1.1	10	0.4	25	1	235	9.3	
H-016	1.6	1	2	30	1.2	26	1	28	1.1	10	0.4	25	1	235	9.3	
H-025	2.5	1	2	40	1.6	33	1.3	36	1.4	13	0.5	34	1.3	279	11	
H-03	3	1	2	40	1.6	33	1.3	36	1.4	13	0.5	34	1.3	279	11	
H-032	3.2	2	5	40	1.6	33	1.3	36	1.4	13	0.5	34	1.3	279	11	
H-05	5	2	5	50	2	43	1.7	34	1.4	16	0.6	41	1.6	334	13.2	
H-10	10	5	10	82	3.2	68	2.7	58	2.3	25	1	56	2.2	440	17.3	
H-12	12.5	5	10	82	3.2	68	2.7	58	2.3	25	1	56	2.2	440	17.3	
H-15	15	5	10	104	4.1	82	3.2	64	2.5	33	1.3	57	2.2	508	20	
H-20	20	10	20	137	5.3	111	4.3	79	3.1	41	1.6	71	2.8	621	24.5	
H-25	25	10	20	169	6.6	146	5.7	99	3.9	51	2	86	3.4	744	29.3	
H-30	30	10	20	169	6.6	146	5.7	99	3.9	51	2	86	3.4	744	29.3	

> The company reserves the right to make changes without notice.

\* C & E dimensions subject to change. For current dimensions - contact us.

## OPTIONS



- > Optional Backlight
- > 1 or 2 user-adjustable set points
- > Additional 0.5"/12mm LCD display with cable connection to indicator or wireless
- > Additional 1"/25mm LCD display with cable connection to indicator or wireless
- > Additional 2"/50mm LCD display with cable connection to indicator or wireless
- > Additional 5"/125mm LED display with cable connection to indicator or wireless
- > Additional extension cable in 15ft/5m increments
- > Analog output: 0 to 3V
- > Analog output: 4 to 20 mA
- > Dampened display for unstable loads
- > Automatic/Manual Data Logger - Up to 50,000 measurements
- > IP 67 load cell with special offshore capability
- > Longer extension cable in 15ft/5m increments
- > Number of measurements per second: 1, 2, 3, factory set
- > Real-time clock: date, hour, minute, second adds time stamp to RS-232 output
- > Rechargeable batteries with an external charger
- > RS-232 - continuous or on demand data output, user-selectable
- > RS-485 - continuous or on demand data output, user-selectable
- > Totalizer
- > Totalizer with Data Logging
- > USB