

Load Monitoring - Crane Scales

Ron 2501 Hook Type Wireless Crane Scale

ADVANTAGES



5 year warranty

Portable: Lightweight and small.

Highly Accurate: $\pm 0.1\%$ of full range - important for early overload detection.

Long transmission Range: Up to 150m/yds. Up to 3.2 Km / 2 Miles upon request (outdoor, line of sight).

Excellent battery life: Up to 2000 Hours (2x AA batteries). Optional 4000h.

Quality Materials: Exclusive use of high strength aerospace quality steel for load cell bodies.

Fatigue rated: All Eilon Engineering load cells are Fatigue Rated according to ASME BTH-1 and IEC 61508. Fatigue Rated means an unlimited number of load cycles (Provided capacity is not exceeded).

Robust: Heavy duty designs with shock absorbing mechanisms.

Unique: Shackle holes offset 90 degrees reduce external moments for greater safety and accuracy.

Minimal Headroom loss: Smallest on the market - important for indoor applications.

Multi-point: Up to 200 different load cells controlled by a single receiver and all measurements are presented on one screen as a real time load map.

Advanced options: Auto/Manual Data Logger, RS232, Additional Displays.

Short delivery time: In most cases 48-72 hours.

More than 45 years in the market with repeat customers such as NASA, Boeing, Cirque du Soleil, Disney, GE, Lockheed Martin, other Fortune 500 companies, as well as numerous small businesses.



TECHNICAL SPECIFICATIONS



Safety factor: Load cell body - 5:1. Hook - at least 4:1

Accuracy: 0.1% of full range.

Transmission Range: Up to 150m/yds. Up to 3.2 Km / 2 Miles upon request (outdoor, line of sight).

Calibration: User calibration. Initial factory calibration, fully traceable (certified).

Load Cell Material: high-strength, aerospace quality, alloy steel, polyurethane coated.

Proof Load: Each system proof-loaded to 200% of capacity (certified)

Display: 6 digits, 1/2" (12mm) liquid crystal display. Overload warnings (100%/130%), low battery indication, Gross/Net. Refresh rate 1Hz.

Sampling Rate: 200 per second.

Functions: Zero, Tare, Battery level indication, Low battery warning, Max. (peak hold), User calibration.

Units: User selectable units (metric tons, short tons, kgs., lbs., Newtons, Deca-Newtons, Kilo-Newtons).

Indicator/Load Cell Housing: High quality ABS.

Temperature Range:

Load cell: -15°F to $+175^{\circ}\text{F}$ (-25°C to $+80^{\circ}\text{C}$)

Indicator: -4°F to $+158^{\circ}\text{F}$ (-20°C to $+70^{\circ}\text{C}$)

Environmental:

Load Cell: IP67

Indicator: IP65

Capacities 0.5t - 15t
(Clevis Hook)

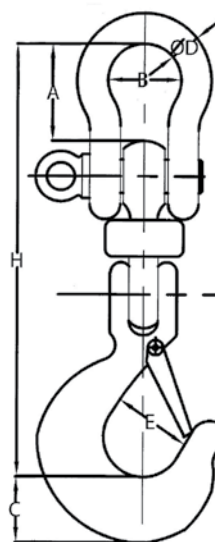

Capacities 20t - 30t
(Eye Hook)

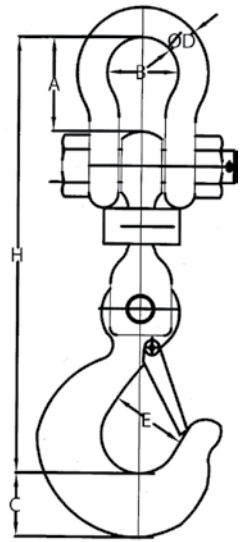

Cat no.	Capacity		Resolution		A		B		C*		Ø D		E*		H	
	ton	kg.	lbs	mm.	inch	mm.	inch	mm.	inch	mm.	inch	mm.	inch	mm.	inch	
H-005	0.5	0.1	0.2	28	1.1	26	1	28	1.1	10	0.4	23.5	0.9	224	8.8	
H-01	1	0.2	0.5	28	1.1	26	1	28	1.1	10	0.4	23.5	0.9	224	8.8	
H-0125	1.25	0.2	0.5	28	1.1	26	1	28	1.1	10	0.4	23.5	0.9	224	8.8	
H-016	1.6	0.5	1	28	1.1	26	1	28	1.1	10	0.4	23.5	0.9	224	8.8	
H-02	2	0.5	1	28	1.1	33	1.3	28	1.1	13	0.5	23.5	0.9	224	8.8	
H-025	2.5	0.5	1	38	1.5	33	1.3	34	1.3	13	0.5	28	1.1	250	9.8	
H-03	3	0.5	1	38	1.5	33	1.3	34	1.3	13	0.5	28	1.1	250	9.8	
H-0315	3.15	0.5	1	38	1.5	33	1.3	34	1.3	13	0.5	28	1.1	250	9.8	
H-05	5	1	2	49	1.9	43	1.7	40	1.6	16	0.6	34	1.3	315	12.4	
H-10	10	2	5	77	3	68	2.7	60	2.3	26	1	52	2	424	16.7	
H-12	12.5	2	5	77	3	68	2.7	60	2.4	26	1	52	2	424	16.7	
H-15	15	2	5	92	3.6	74	2.9	52	2	28	1.3	60	2.4	453	17.8	
H-20	20	5	10	110	4.3	92	3.6	75	3	36	1.6	77	3	520	20.5	
H-25	25	5	10	169	6.7	146	5.7	91	3.6	51	2	94	3.7	774	30.5	
H-30	30	5	10	169	6.7	146	5.7	91	3.6	51	2	94	3.7	774	30.5	
H-315	31.5	5	10	169	6.7	146	5.7	91	3.6	51	2	94	3.7	774	30.5	
H-32	32	5	10	169	6.6	146	5.7	89	3.5	51	2	87	3.4	643	25.3	

> The company reserves the right to make changes without notice.

* C & E dimensions subject to change. For current dimensions - contact us.

OPTIONS



- > Optional Backlight
- > Additional 0.5"/12mm LCD display with cable connection to indicator or wireless
- > Additional 1"/25mm LCD display with cable connection to indicator or wireless
- > Additional 2"/50mm LCD display with cable connection to indicator or wireless
- > Additional 5"/125mm LED display with cable connection to indicator or wireless
- > Battery life: Extended battery life of up to 4000 hours
- > Dampened display for unstable loads
- > Automatic/Manual Data Logger - Up to 50,000 measurements
- > Multi-cell: Up to 8 different load cells controlled by a single indicator.
- > Multiple load monitoring: up to 200 load cells, please see Ron StageMaster
- > Number of measurements per second: 1, 2, 3, factory set

- > Real-time clock: date, hour, minute, second adds time stamp to RS-232 output
- > Robust, extruded aluminum, hand-held indicator instead of ABS (1"/25mm or 2"/50mm digits)
- > Rechargeable batteries with an external charger.
- > RS-232 - continuous or on demand data output, user-selectable
- > RS-485 - continuous or on demand data output, user-selectable
- > Totalizer
- > Totalizer with Data Logging
- > USB

High Temperature Options:

- > Heat shield for the load cell
- > Internal load cell thermometer for load cell temperature display on the hand-held indicator
- > Optional Backlight
- > Dampened display for unstable loads